

# microFlu

## CDOM, chlorophyll or cyanobacteria miniature fluorometer

microFlu fluorometer are low-cost miniaturized submergeable fluorometer for high precision and selective measurement of CDOM (Coloured Dissolved Organic Matter), chlorophyll-A or cyanobacteria. The combination of low power consumption, innovative nano coating as energy- and environmental neutral fouling protection and long term stability makes it suitable for monitoring in rivers, lakes, seawater and for all applications in the field of water quality and waste water monitoring. Internal reference measurement of the emitted light compensates aging effects of the high-efficient LEDs, used for fluorescence excitation.

- high sensitivity
- wide operation range
- nano coated windows against fouling
- fast acquisition
- electronic daylight compensation
- miniaturized design
- low power consumption
- low cost
- easy to handle
- RS232 interface
- fully RS232 controllable
- 0..5V analog output
- Windows software for PC access
- controllable with TriBox2 or 3rd party controller
- accessories for portable applications with smartphones available



# microFlu

## Info

	<i>microFlu-CDOM</i>	<i>microFlu-chl</i>	<i>microFlu-blue</i>
light source	ultra-bright UV-LED	ultra-bright blue LED	ultra-bright red LED
excitation wavelength	370nm peak	470nm peak	620nm peak
output energy controlled by internal reference diode; LEDs with interference filter			
detector	460nm peak, 100nm FWHM	685nm peak, 20nm FWHM	655nm peak, 11nm FWHM
ranges	0..20µg/l, 0..200µg/l, auto-ranging (RS232 only) or preset		
sensitivity	0.2 µg/l	0.02 µg/l	0.02 µg/l
interface	RS232 (internal command interpreter for measurement control) and one 0..5V analog control		
calibration coefficients stored internally			
power supply	5 - 15 VDC, max. 200mW		
housing	seawater resistant plastic, stainless steel (1.4571) or titanium		
size	d= 48mm, length= 217mm (without connector)		
depth range	500m or 6,000m deepsea version		
connector	SubConn micro series 5 pin, male		
weight in air	0.5 kg (titanium), 0.7 kg (stainless steel)		
operation temperature	0 - 40°C		

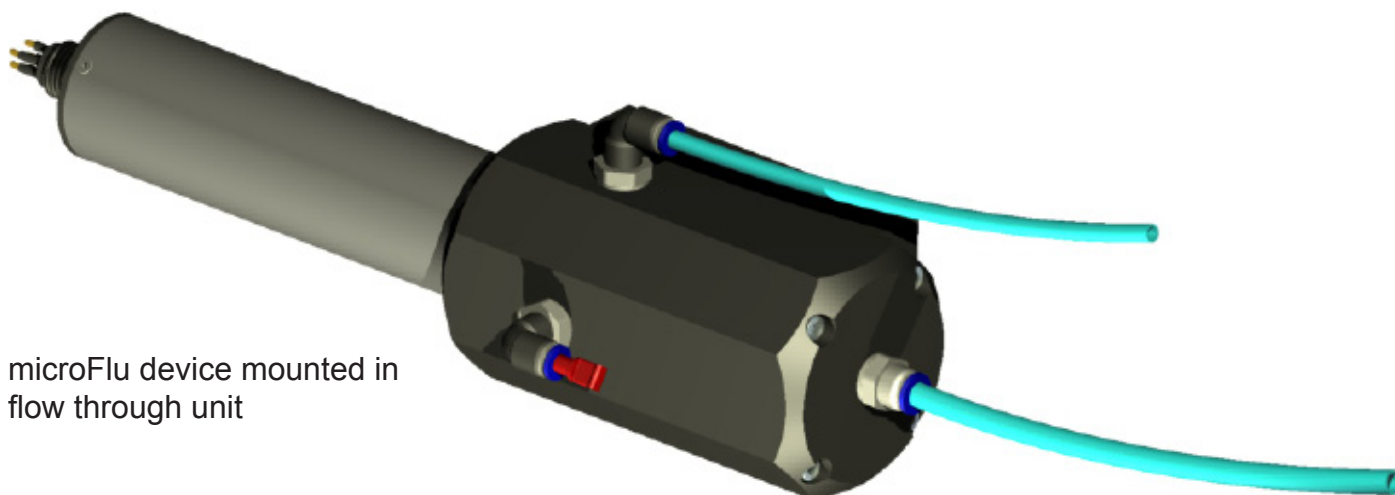

microFlu device mounted in flow through unit

## order codes

10 1000	microFlu-blue (stainless)	20 6012	flow through unit
10 1001	microFlu-blue <sub>Ti</sub> (titanium)	20 1000	PS101 (1 channel)
10 1002	microFlu-CDOM (stainless)	20 1010	IPS104/2+ (2 channels)
10 1003	microFlu-CDOM <sub>Ti</sub> (titanium)	20 1013	IPS104/3+ (3 channels)
10 1004	microFlu-chl (stainless)	20 1017	IPS104/4+ (4 channels)
10 1005	microFlu-chl <sub>Ti</sub> (titanium)	41 0000	TriBox2 (controller), 85 - 265VAC
70 4001	air clean head	41 0001	TriBox2 (controller), 24VDC
contact us for customized solutions or the microFlu deepsea version			