

LS-750P (p/n 016-4151) is a Gems Sensors UK factory hybrid unit assembled for Control Components made up of the PP parts of the **LS-3** (p/n 142545 - see below) and the cable, cable gland & brass weight of **LS-750** (p/n 149350 - see next page) to yield the unit pictured on the last page. It comes with a 7.5m cable.

LEVEL SWITCHES

LS-3 Specials

SINGLE POINT

Unique features make these LS-3 Models special. These small switches feature unique configurations for special applications.



LS-3 Slush Shield

Compact, all-polypropylene switch with slush shield is ideal for use with turbulent liquids in small tanks. FDA approved materials.



LS-3 Bottle Level

For external mounting on tanks too small to accommodate internally mounted switches. (See note below)



LS-3 Low Level

For detecting levels as low as 16mm from tank bottom. Use in water, gasoline, some oils and chemicals.

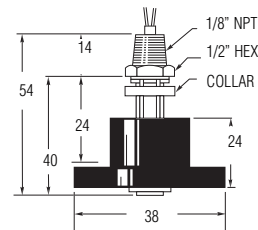
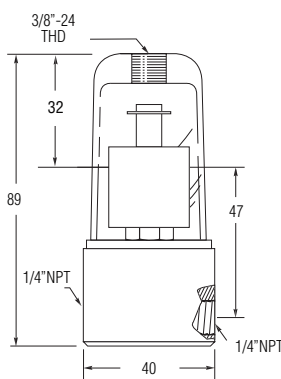
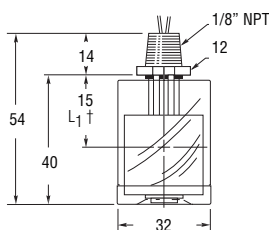

Specifications

	LS-3 Slush Shield	LS-3 Bottle Level	LS-3 Low Level
Materials			
Stem and mounting	Polypropylene ††	Polysulfone	Polysulfone
Float	Polypropylene	Polysulfone	Buna N
Other wetted	—	Brass, Aluminium,	Epoxy Polycarbonate, Viton A
Min. liquid Sp.Gr.	.90	.75	—
Operating temperature	-40°C to +65.6°C	-40°C to +48.9°C	-40°C to +82.2°C
Pressure, bar, Max. ***	10	3	3
Switch, SPST	20 VA, N.C./N.O. Dry**	20 VA, N.C. Dry	20 VA, N.C. Dry
Material compliance			
Electrical termination	No. 22 AWG, 0.6m L., PVC Lead Wires	No. 22 AWG, 1.8m L., Polymeric Lead Wires	No. 22 AWG, 1.8m L., PVC Lead Wires
Mounting	1/8" NPT	3/8 UNF/1/4NPT	1/8" NPT
Protection rating	IP64	IP64	IP64
Weight aprox.	80g	170g	60g

** Switch operation is selectable, N.O. or N.C.. by inverting the float on the unit stem.
 *** Maximum pressure at 70°F (30°C).
 † L₁ = Switch actuation level, nominal (based on a specific gravity of 1.0).
 †† Consult factory for other available materials.

Note: LS-3 Series Bottle Level Switch is also available with any of the float materials shown on LS-3 page. Contact GEMS for correct part number.

How to Order

LS-3 Slush Shield	LS-3 Bottle Level	LS-3 Low Level
142545	46999	76707

Standard Products in **bold**

Bilge water level switches

The design of GEMS bilge water level switches combines reliable switching in contaminated liquids with compact dimensions. These switches have been developed for general naval and industrial applications. They have protective housings which dampen the movements and turbulence of the medium and maintain their reliable operation even if there is solid matter in the bilge water.

Acceptance and Approvals

Various civil, military and naval approvals are on hand for many of these products. Please ask for further details.

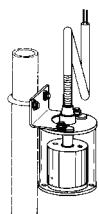
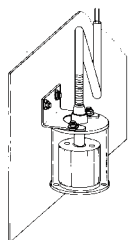

Germanischer Lloyd
GL (Germany)



Germanischer Lloyd
GL (Germany)



LS-750

Applications

LS-240-3E: This switch has extremely robust construction. It is perfectly suitable for applications on ships and wherever heavy mechanical loads occur. The LS-240-3E has been accepted by the Germanischer Lloyd, among others, and approved for application by the German Navy.

LS-270-E: This bilge water level switch has been developed especially for low level alarms and can monitor levels as low as 35 mm. As the cable is vulcanized the switch is submersible to "IP67". The float can also be constructed as an interface level indicator.

~~The LS-270-E has been accepted by the Germanischer Lloyd, among others, and approved for application by the German Navy.~~

LS-750: With a compact-sized float, slosh shield and weighted collar, the LS-750 provides liquid level detection for a wide variety of applications. Suspend in stand pipes or sumps for leak detection duty, or drop into wells for ground-water monitoring. Supplied with 7.5m of waterproof cable.

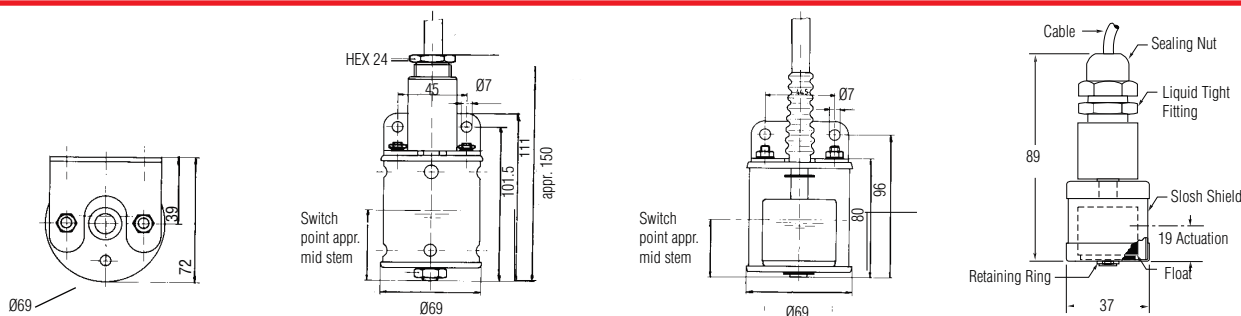

Specifications

	LS-240-3E	LS-270-E	LS-750
Material stem	S Steel	S Steel	Brass
Material float:	Buna N	Buna N	Buna N
Stilling chamber	S. Steel	Lucite	Brass
Bracket	S Steel	S Steel	
Operating pressure	10 bar	10 bar	10 bar
Temperature -40°C to	+80°C	+80°C	+80°C Water
Min. specific gravity of the liquid	0.53	Standard: 0.58 Interface level: 0.85/1	0.45
Protection rating	IP67	IP67	IP68 to 8m
Type of reed switch	SPST 100 VA	SPST 100 VA	N.C., 20VA
Electrical connection	(Length 2m) Cable: LMGSGO 2 x 1.5mm2	(Length 2m) Cable: CR 3x1.5mm2	(Length 7.5m) PVC Cable Jacket 22 AWG
Weight	650 g	530 g	830 g

How to Order

STD Float	010-3433 NO.	010-3434 NC	010-0349 NO	010-0350 NC	149350 NC
Interface Float Oil/Water			010-0351 NO	010-0352 NC	

Connecting Diagram

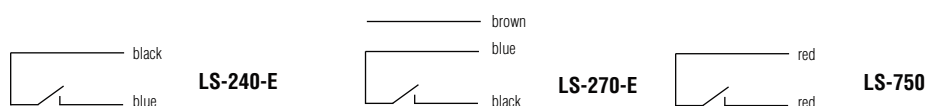

Standard Products in **bold**



Gems LS-750P:
• p/n: 016-4151