

Overview and Selection Guide		Page
<a href="#">Installation</a>		2
<a href="#">Information for electrical Reed switches</a>		3

Type	old version	Function	Media Temp.	Electric Data	Remarks	Page
<a href="#">37160-NN</a>	37160	SPDT	-50°C...+150°C	230V/1A/60VA/60W	Standard	4
<a href="#">37160-NS</a>		SPDT	-50°C...+150°C	230V/1A/60VA/60W	with ss-cable gland	5
<a href="#">37160-NM</a>		SPDT	-50°C...+150°C	230V/1A/60VA/60W	with brass cable gland	6

**Type code**

**Switch Function**  
SPDT

**Version**  
new ss-switches with metric cable gland

**Execution**  
Standard with PA cable gland  
with ss-cable gland  
with brass cable gland

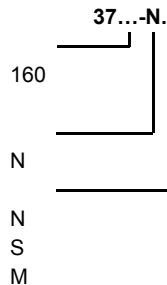

This data sheet set applies to Weka type 37160/xx magnetic switches manufactured after June 2008. Switches made before this time have Blue rather than Grey conductors to common terminal of switch.

**Mounting**

**Normal:** Valid is the indicated switching function on the type label (float below switch)  
 Installation 180 °C opposite of the indication rail with the permitted tolerance according to the tube diameter  
 Cable exit downwards

**Variation:** Each of the following variants leads to a reversion of the indicated switching logic  
 Mounting with cable exit upwards  
 Mounting adjacent to the indication rail

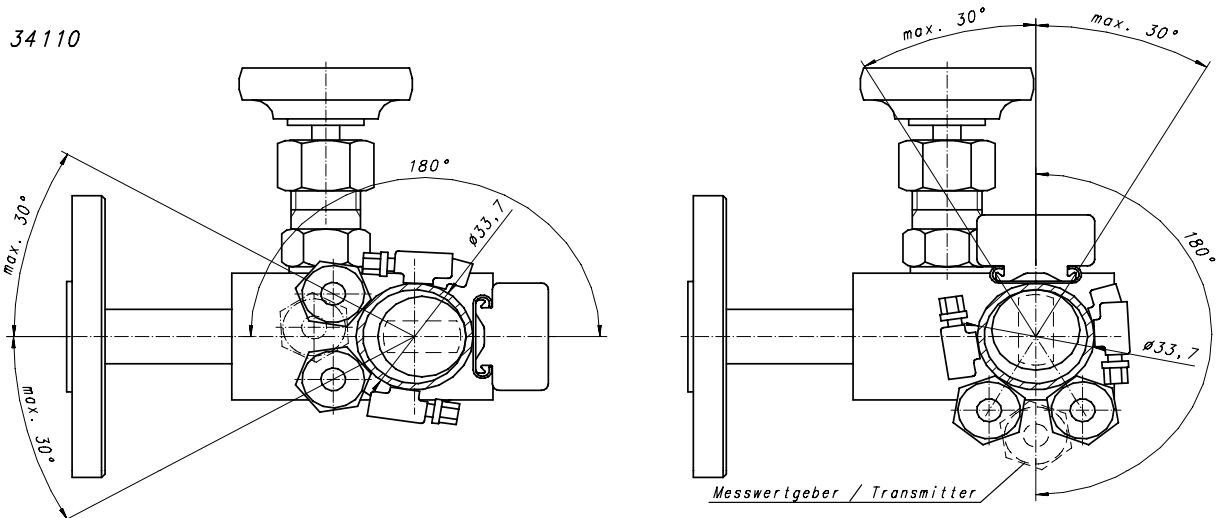
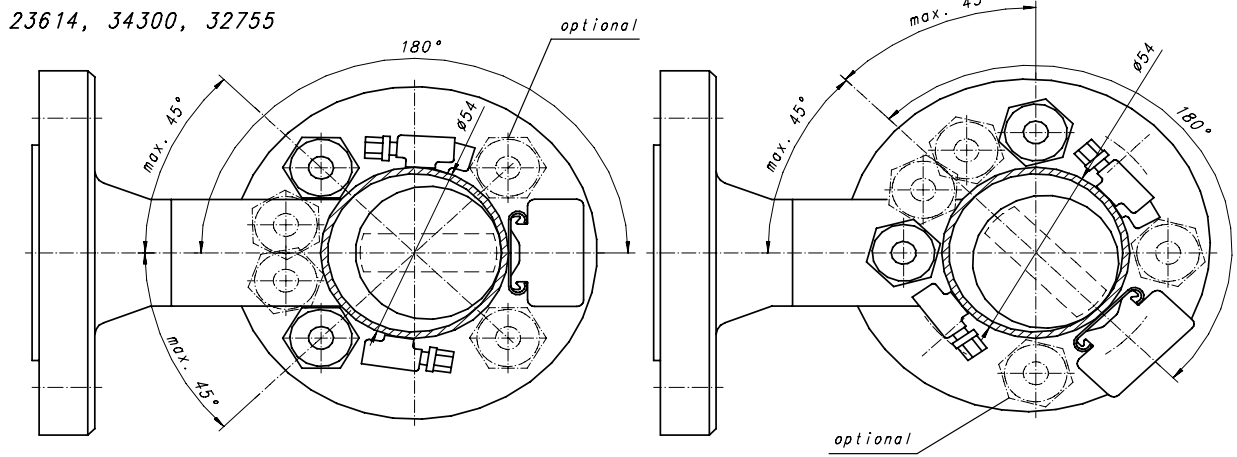
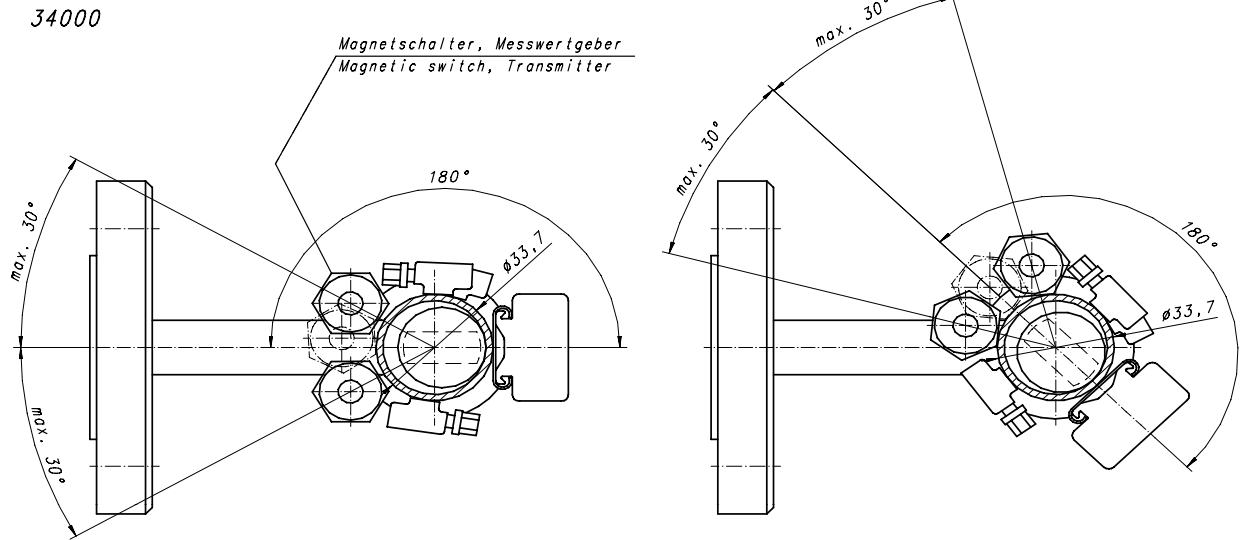

**Caution:**

Read this information before installing level indicators that have magnetic switches.

Use of magnetic switches with inappropriate contact ratings can result in damage to the magnetic switches and malfunctioning of level indicators.

For Ex rated magnetic switches (311x0-NI / -ND) it is necessary to adhere to the specified limit values of electrical parameters of the circuit.

**Construction:**

The key element of a Weka magnetic switch module or sub-assembly is a reed switch.

A reed switch consists of two pieces of special flattened wire (the reeds or "paddles") hermetically sealed in a glass capsule. The reed switch is actuated by the magnetic field of the float. The glass capsule is filled with an protective gas that ensures high electrical life expectancy of millions of switching cycles.

**Contact rating (resistive loads):**

	Typ	Contact rating
N/O or N/C switches	31130 -NN	max. 250V max. 1A max. 220VA max. 160W
	31130 -NW	
	31130 -NA	
	31130 -NK	
	31130 -NI	
	31130 -ND	
	31130 -NM	
	31130 -NS	
Changeover switches	31160 -NN	Also 37160-N* max. 250V max. 1A max. 60VA max. 40W
	31160 -NW	
	31160 -NA	
	31160 -NK	
	31160 -NI	
	31160 -ND	
	31160 -NM	
	31160 -NS	

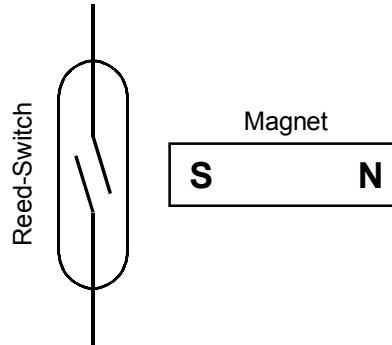

These values apply only for resistive loads.  
For inductive loads, see below.

**Note:**

None of the specified values may be exceeded.

**Caution:**

For many resistive load applications, the electrical circuit can have inductance and / or capacitance. Voltage spikes of 6 to 7 times the normal values can occur when switching off inductive loads. This can sometimes result in the contacts getting welded together, destroying the switch.

Examples of inductive loads are transformers, solenoid operated devices (valves, contactors), some types of wound-filament lamps, etc.

**Protecting magnetic switches used with inductive loads:**

**Figure 1 (D.C.)**

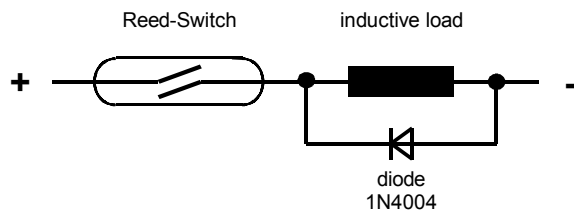

**For D.C. applications:**

A diode connected across the load coil short circuits the reverse voltage spike that occurs when the supply is switched off, thus protecting the switch contacts.

**Figure 2 (A.C.)**

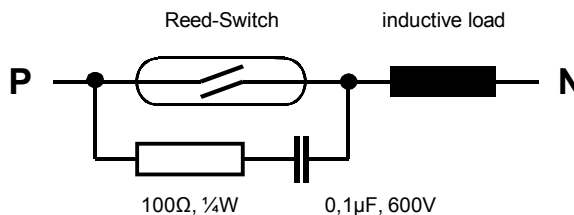

**For A.C. applications:**

A resistor and capacitor in series connected across the switch forms a high impedance path at normal A.C. frequencies. This impedance turns low at high frequencies, diverting spikes currents from the switch.

**External electrical connections**

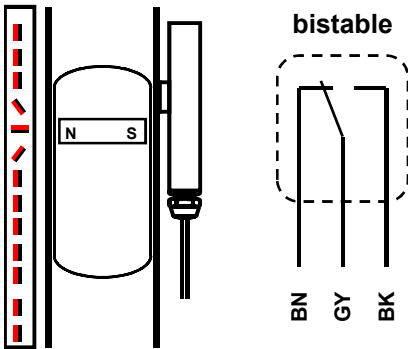

- Installed opposite the indication rail
- Cable exit downwards

**Dimensions**

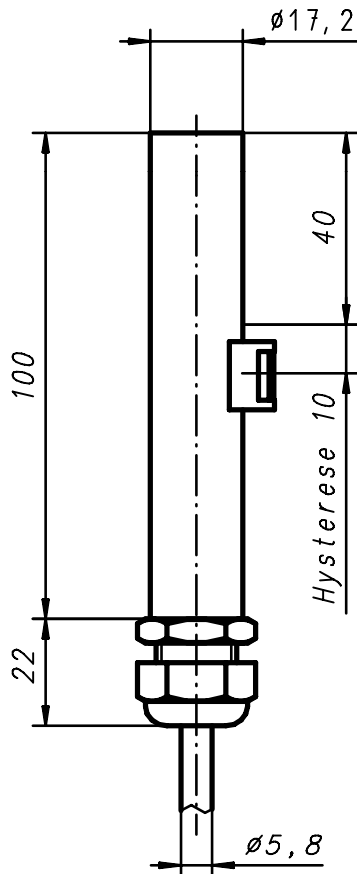

**Function**

**Magnetic switch for  
WEKA Visual Level Indicators**

The switch module is attached to the float chamber, diametrically opposite the indication rail, with cable-exit below (see data sheet 20010501). The float magnet activates the reed contact when the liquid in the float chamber reaches that level. The switching logic is reversible by installing the switch module adjacent to the indication rail, or alternatively by inverting the switch module with cable-exit upwards.

Please refer to the safety guidelines.

**Product code**

<b>37160-NN/3</b>	<b>with 3m cable</b>
<b>37160-NN/5</b>	<b>with 5m cable</b>
<b>37160-NN/10</b>	<b>with 10m cable</b>
<b>37160-NN/20</b>	<b>with 20m cable</b>

**Switching logic**

**Change over, bistable**

**Contact rating**

max.	230V
max.	1A
max.	60VA
max.	60W

**Enclosure**

IP68 - 5bar (EN 60529)

**Material**

Housing	Stainless steel 316 /316L
Cable gland	PA6, grey, 3...8mm
Seal	Perbunan (NBR)
Cable	LiYY, grey, $\phi$ 5.8mm
Shield	not shielded
Cable cores	3 x 0,75mm <sup>2</sup>
Core colours	BK, GY, BN
Tag label	Polyester, yellow, black writing

**Operating conditions**

Media temperature	Ambient temperature
-50°C...+150°C	-20°C...+80°C

Media temperature  
Ambient temperature

Temperature of liquid within the float chamber  
Temperature of air around the magnetic switch

**Fixation**

If ordered together with a VLI fixation is included in the delivery  
If fixation is ordered separately please indicate tube diameter

for tube diameter	30...40mm	Article no.	80648
for tube diameter	40...57mm and 57...80mm	Article no.	84043

**Remarks**

The switch is maintenance free.

**External electrical connections**

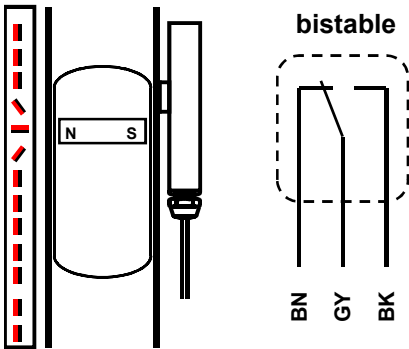

- Installed opposite the indication rail
- Cable exit downwards

**Dimensions**

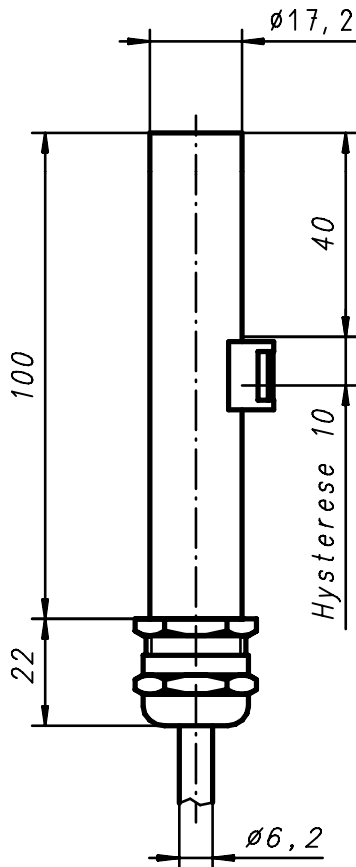

**Function**

**Magnetic switch for WEKA Visual Level Indicators**

The switch module is attached to the float chamber, diametrically opposite the indication rail, with cable-exit below (see data sheet 20010501). The float magnet activates the reed contact when the liquid in the float chamber reaches that level. The switching logic is reversible by installing the switch module adjacent to the indication rail, or alternatively by inverting the switch module with cable-exit upwards.

Please refer to the safety guidelines.

<b>Product code</b>	<b>37160-NS/3</b>	<b>with 3m cable</b>
	<b>37160-NS/5</b>	<b>with 5m cable</b>
	<b>37160-NS/10</b>	<b>with 10m cable</b>
	<b>37160-NS/20</b>	<b>with 20m cable</b>

**Switching logic**

**Change over, bistable**

<b>Contact rating</b>	max.	230V
	max.	1A
	max.	60VA
	max.	60W

**Enclosure**

IP68 - (EN 60529)

**Material**

Housing	Stainless steel 316 /316L
Cable gland	Stainless steel, 1.4436, 5...10mm
Seal	FPM
Cable	LiYY, grey, Ø 5.8mm
Shield	not shielded
Cable cores	3 x 0,75mm <sup>2</sup>
Core colours	BK, GY, BN
Tag label	Polyester, silver, black writing

**Operating conditions**

Media temperature	Ambient temperature
-50°C...+150°C	-20°C...+80°C

Media temperature	Temperature of liquid within the float chamber
Ambient temperature	Temperature of air around the magnetic switch

**Fixation**

If ordered together with a VLI fixation is included in the delivery

If fixation is ordered separately please indicate tube diameter

for tube diameter	30...40mm	Article no.	80648
for tube diameter	40...57mm and 57...80mm	Article no.	84043

**Remarks**

The switch is maintenance free.

**External electrical connections**

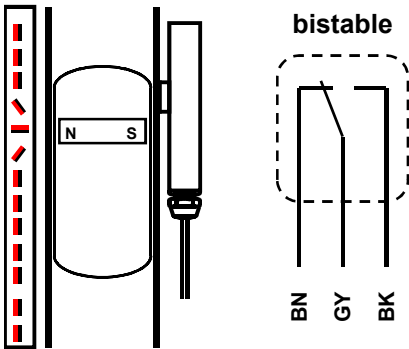

- Installed opposite the indication rail
- Cable exit downwards

**Dimensions**

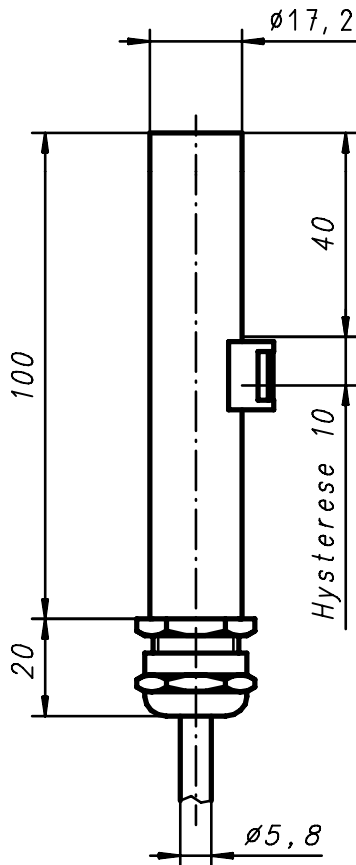

**Function**

**Magnetic switch for  
WEKA Visual Level Indicators**

The switch module is attached to the float chamber, diametrically opposite the indication rail, with cable-exit below (see data sheet 20010501). The float magnet activates the reed contact when the liquid in the float chamber reaches that level. The switching logic is reversible by installing the switch module adjacent to the indication rail, or alternatively by inverting the switch module with cable-exit upwards.

Please refer to the safety guidelines.

**Product code**

<b>37160-NM/3</b>	<b>with 3m cable</b>
<b>37160-NM/5</b>	<b>with 5m cable</b>
<b>37160-NM/10</b>	<b>with 10m cable</b>
<b>37160-NM/20</b>	<b>with 20m cable</b>

**Switching logic**

**Change over, bistable**

**Contact rating**

max.	230V
max.	1A
max.	60VA
max.	60W

**Enclosure**

IP68 - 5bar (EN 60529)

**Material**

Housing	Stainless steel 316 /316L
Cable gland	Brass, nickel-plated, 5...10mm
Seal	Perbunan (NBR)
Cable	LiYY, grey, $\varnothing$ 5.8mm
Shield	not shielded
Cable cores	3 x 0,75mm <sup>2</sup>
Core colours	BK, GY, BN
Tag label	Polyester, silver, black writing

**Operating conditions**

Media temperature	Ambient temperature
-50°C...+150°C	-20°C...+80°C

Media temperature  
Ambient temperature

Temperature of liquid within the float chamber  
Temperature of air around the magnetic switch

**Fixation**

If ordered together with a VLI fixation is included in the delivery  
If fixation is ordered separately please indicate tube diameter

for tube diameter	30...40mm	Article no.	80648
for tube diameter	40...57mm and 57...80mm	Article no.	84043

**Remarks**

The switch is maintenance free.