

Flow Switches – Liquid (continued)

Series FS7-4E

Industrial Liquid Flow Switches

- For hazardous environment applications requiring a **NEMA 7 (Class I, Group C or D) or NEMA 9 Class II, Group E, F, or G** rated flow switch
- 1¼" (32mm) NPT
- Brass with sealed tube construction
- Single pole, double throw snap switch
- Magnetic switching mechanism
- Sensitivity adjusting screw makes flow adjustment easy
- Paddles can be trimmed to suit application needs
- Optional features
 - Extended paddle arm
 - Stainless steel
 - BSPT threads
 - Sprinkler service (UL & ULC listed)
- Minimum temperature (fluid or ambient) 32°F (0°C)
- Maximum temperature 300°F (149°C)
- Maximum operating pressure
 - 300 psi (21 kg/cm²)
 - 1000 psi (70 kg/cm²) – Stainless Steel models

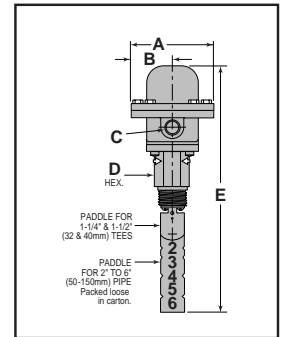
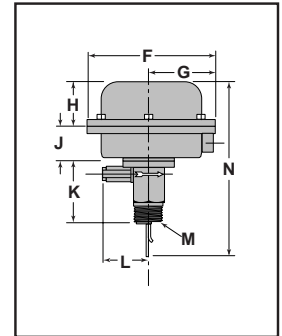

Electrical Ratings

Voltage	Motor Switch Rating (Amperes)		Pilot Duty
	Full Load	Locked Rotor	
120 VAC	7.4	44.4	125 VA at 120 or 240 VAC 50 or 60 cycles
240 VAC	3.7	22.2	

Dimensions, in. (mm)

A	B	C NPT	D	E	F	G
4 ⁵ / ₈ (117)	2 ⁵ / ₁₆ (59)	1/2 (25)	1 ³ / ₄ (45)	13 ³ / ₄ (350)	7 ¹ / ₄ (184)	3 ²⁵ / ₃₂ (96)
H	J	K	L	M NPT	N	
2 ⁷ / ₁₆ (62)	1 ¹⁵ / ₁₆ (24)	3 ⁷ / ₁₆ (87)	2 ⁵ / ₈ (67)	1 ¹ / ₄ (32)	9 ¹¹ / ₁₆ (246.6)	

Flow Rates

Pipe Size NPT in. (mm)	Settings	Mode of Operation		Max. Flow Rate (GPM) w/o Paddle Damage
		Flow gpm (lpm)	No Flow gpm (lpm)	
1¼ (32)	Factory or Minimum	4.8 (18.2)	3 (11.4)	47
	Maximum	7.7 (29.1)	5.9 (22.3)	
1½ (40)	Factory or Minimum	6.3 (23.8)	3.6 (13.6)	63
	Maximum	10 (37.9)	7 (26.5)	
2 (50)	Factory or Minimum	9.9 (37.5)	5.9 (22.3)	105
	Maximum	15.8 (59.8)	11 (41.6)	
2½ (65)	Factory or Minimum	15.3 (57.9)	9.5 (36)	149
	Maximum	23.7 (89.7)	17 (64.3)	
3 (80)	Factory or Minimum	24.4 (92.4)	15.4 (58.3)	230
	Maximum	35.5 (134.4)	29.2 (110.5)	
4 (100)	Factory or Minimum	33.3 (126)	21.1 (79.9)	397
	Maximum	61.4 (232.4)	37.7 (142.7)	
5 (125)	Factory or Minimum	44.4 (168.1)	31 (117.3)	654
	Maximum	84 (317.9)	51 (193)	
6 (150)	Factory or Minimum	56.3 (213.1)	48.7 (184.3)	900
	Maximum	114.8 (434.5)	71 (270.6)	
8 (200)*	Factory or Minimum	104 (393.6)	89 (336.9)	1,500
	Maximum	210 (794.9)	131 (495.8)	
10 (250)*	Factory or Minimum	184 (696.4)	157 (594.2)	2,500
	Maximum	369 (1397)	231 (874.3)	
12 (300)*	Factory or Minimum	289 (1094)	247 (934.9)	3,500
	Maximum	582 (2203)	363 (1374)	
14 (355)*	Factory or Minimum	387 (1465)	323 (1223)	4,000
	Maximum	753 (2850)	495 (1874)	
16 (405)*	Factory or Minimum	513 (1942)	428 (1620)	5,000
	Maximum	998 (3777)	656 (2483)	

Values are ± 10%

* Equipped with a 6" (152mm) paddle

Ordering Information

Model Number	Part Number	Description	Weight lbs. (kg)
FS7-4E	120100	Industrial flow switch NEMA 7 & 9 rated	12.3 (5.6)
FS7-4EJ	120135	FS7-4E w/BSPT threads	12.7 (5.8)
FS7-4EL	120150	FS7-4E w/extended paddle arm	12.3 (5.6)
FS7-4ELJ	120158	FS7-4EL w/BSPT threads	12.7 (5.8)
FS7-4SE	120175	FS7-4E w/Stainless steel	11.7 (5.3)
FS7-4SEJ	120186	FS7-4EJ w/BSPT threads	12.0 (5.4)

NOTE: DO NOT USE LIQUID FLOW SWITCHES ON SYSTEMS WITH FLOW GREATER THAN 10 FEET (3M) PER SECOND.