

PS-J and PS-JL Series – OEM Subminiature Pressure Switch

- ▶ 2 to 3000 PSI (0.1 to 210 bar) Pressure Range
- ▶ Field or Factory Set

Gems PS-J Series of pressure switches are designed for OEM applications. The switches are equipped with high proof pressure capabilities for demanding applications, but are economically priced by using metal blade contacts in lieu of a microswitch. The switches can be field or factory adjusted.

Specifications

Process Temperature	
Buna-N	-4°F to +250°F (-20°C to +120°C)
EPDM*	-40°F to +250°F (-40°C to +120°C)
Viton®	+32°F to +250°F (0°C to +120°C)
Ambient Temperature	
	-40°F to +250°F (-40°C to +120°C)
Switch	
	SPST, 100 VA, 42V max. (>2 million cycles @ 1,000 psi, max. 200 cycles/min.)
Approvals	
	CE
Repeatability	
	3% of Highest Set Point @ 70°F (20°C) (5% PS-JL)
Wetted Parts	
Diaphragm	Buna-N (Optional EPDM or Viton®) (Kapton®, PS-JL)
Fitting	Zinc-Plated Steel (Optional 316 SS) (Brass, PS-JL)
Electrical Termination	
	6.3mm (1/4") Spade or Screw Terminals
Process Fitting	
	G or NPT 1/4" (optional 1/8")
Deadband	
	1-2 psi
Proof Pressure	
	9000 psi (600 bar) (500 psi, PS-JL)
Weight, Approximate	
	0.14 lbs. (0.06 kg)

*Optional

How To Order

Use the **Bold** characters from the chart below to construct a product code.

SELECT

PS -J -1 -4G -A -SP -X

- J or -JL** series
- Insert Range Code from table at bottom right¹
- Pressure Port
-4M 1/4" NPT male; **-4G** G 1/4 male;
-2M 1/8" NPT male; **-2G** G 1/8 male
- Circuit
-A SPST/NO; **-B** SPST/NC
- Electrical Termination²
-SP spade terminals 1/4" x 1/32" (6.3x8mm); **-TS** screw terminals #6-32;
-FL flying leads; **-FLWF** leads with weather pack connector
- Options for PS-J³
-1 Viton® diaphragm; **-2** EPDM diaphragm; **-3** 316 ss on 1/4" fitting; **-6** internal ground;
-7 gold electrical contacts; **-20** IP68 submersible⁴; **-SR** surge restrictor;
-B oxygen cleaned; **-30** rubber boot

Notes:

- For factory set units indicate setting and units followed by **-R** for rising or **-F** for falling
Example: PS-J-50psi-R-4M-A-SP (50 psi, Rising, 1/4" NPT, Normally Open Switch).
- Leads require submersible option.
- Options for PS-JL are **-7**, **-20**, **-30**.
- Submersible option requires wire leads and factory preset set point (unit is not field adjustable).



Dimensions

Submersible Option

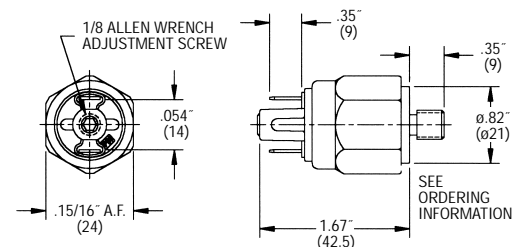
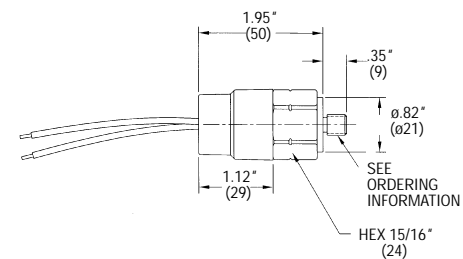

Pressure Range Code	PS-JL Adjustable Range	PS-J Adjustable Range
-1	2-10 psi .15-.7 bar	5-85 psi .35-6 bar
-2	7-25 psi .5-1.7 bar	75-500 psi 5-35 bar
-3	20-60 psi 1.4-4 bar	300-725 psi 21-50 bar
-4	50-150 psi 3.5-10 bar	500-1250 psi 35-85 bar
-5	—	1000-3000 psi 70-210 bar